

**High Pressure 3 Piece Reduced Port Ball Valve**  
**Pressure Rating: 6000 PSI (W.O.G)**  
**Size: 1/8" - 1"**



**AF-39**

## *Features*

- Hexagonal Body: 316SS Barstock
- Compact Design for High Structural Strength
- Blowout Proof Stem
- Ends: Threaded to NPT

## Valve Dimensions

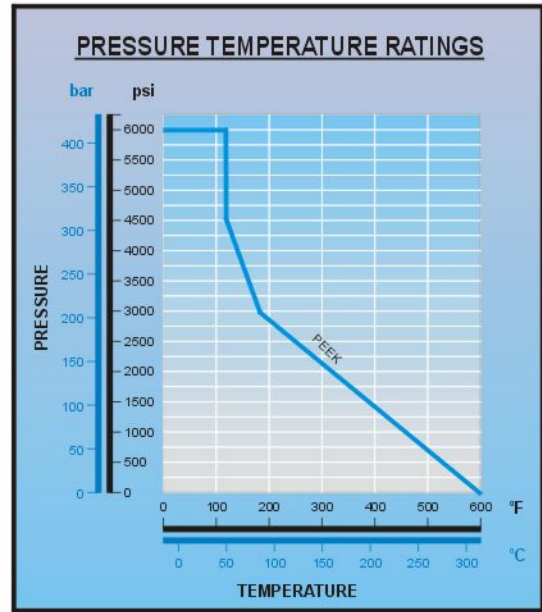
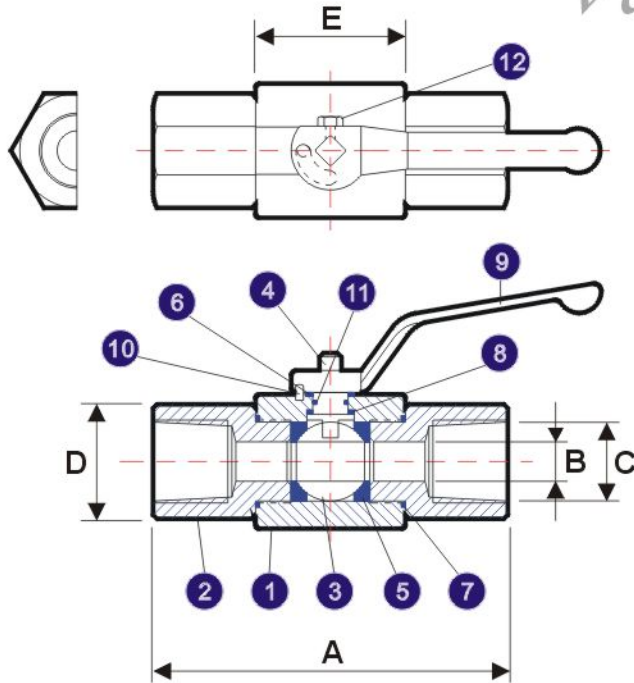

Dimension in mm

Size	A	B	C	D	E
1/8"	84.6	10.0	1/8" NPT	26.8	38.0
1/4"	84.6	10.0	1/4" NPT	26.8	38.0
3/8"	84.6	10.0	3/8" NPT	26.8	38.0
1/2"	84.6	10.0	1/2" NPT	26.8	38.0
3/4"	95.0	13.0	3/4" NPT	32.0	40.0
1"	116.0	19.0	1" NPT	41.0	60.0

## Material Specifications

### How To Order

AF-39      02

Type	Size	
AF-39	01	1/8"
	02	1/4"
	03	3/8"
	04	1/2"
	05	3/4"
	06	1"

NO.	PART	STAINLESS STEEL	QTY
1	BODY	ASTM A182 F316	1
2	SEAT RETAINER	ASTM A182 F316	2
3	BALL	ASTM A351 Gr. CF8M	1
4	STEM	ASTM A276 Gr.316	1
5	SEATS	PEEK	2
6	STEM PACKING	PEEK	1
7	O-RING	VITON	2
8	THRUST WASHER	PEEK	1
9	HANDLE	SS 304	1
10	PIN	SS 304	1
11	O-RING	VITON4	1
12	HANDLE BOLT	SS 304	1